

SPEAKEASY 6

CORDED TELEPHONE WITH CALLER DISPLAY AND ANSWERING MACHINE

USER GUIDE

Unpacking your SPEAKEASY 6

In the box are:

- **Base Unit**
- **Handset**
- **Coiled Handset cord**
- **Mains power adaptor**
for Base Unit
- **Telephone line cord** for
Base Unit
- **Mount Bracket**
- **2 Screws** for wall
mounting
- **User manual**



Keep the packaging materials
in a safe place in case you later
need to transport the unit.

**Keep your sales (till) receipt,
which is your guarantee.**

Binatone

If you need help ...

The **Binatone Help Line** is available
from 9.00 am to 5.00 pm, Monday
to Friday, on

0845 345 9677

Calls are charged at Local Call rate.

Important note — emergency calls

**If you ever need to make an emergency call during a mains
power failure, you'll need to lift the Handset - the speakerphone
will not work without mains power.**

I. Where to find it

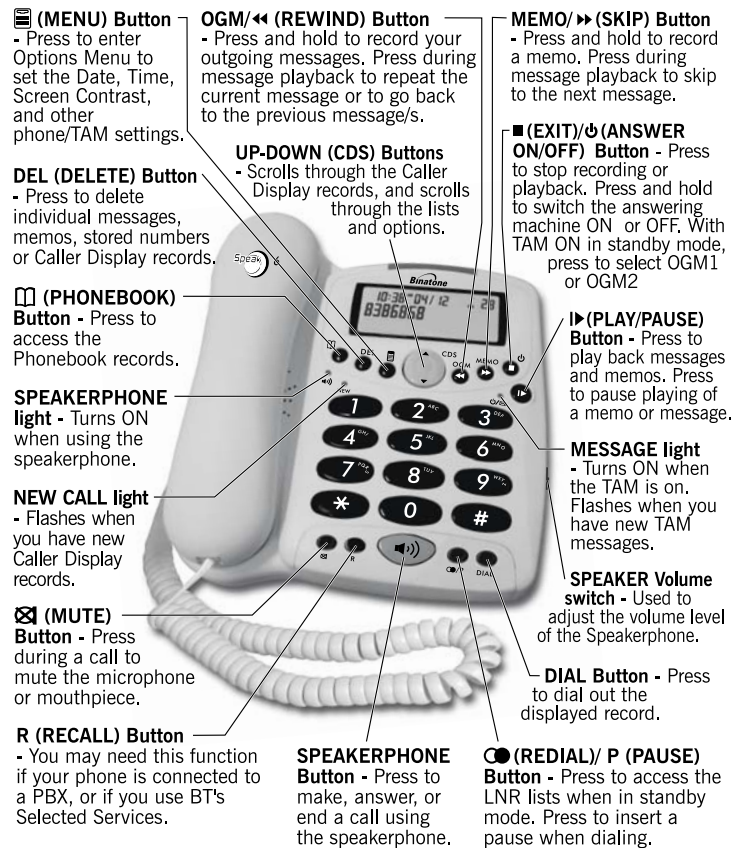

Important:

- When the instruction simply say 'press' a button, this means you should press it briefly then release it.
- When the instruction say 'press and hold' a button, this means you should keep it pressed until the display changes or you hear a tone.



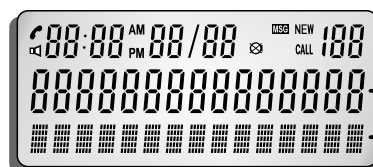





Display messages and symbols

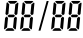

Number field: It shows the telephone number and the number of messages.

Letter field: It shows the name, and the status of a call/message.

The LCD screen icons:

	Phone	You are connected to the telephone line - your Handset is 'offhook'.
	Time	Displays the time.
	Date/Month	Displays the day and month setting.
	Caller Display Record	Shows the total number of Caller Display records when the caller display is being received or when the call lists is being viewed.
	NEW	Appears when you have new messages and/or Caller Display records.
	Message	Appears only when viewing a Caller display list with a recorded answering machine message.
	Mute	Appears when you press the MUTE button to mute the mouthpiece or microphone.
	Speakerphone	Appears when the speakerphone function is turned ON.

Binatone Help Line - 0845 345 9677

Calls are charged at Local Call rate.

2. Installation

1. Locating the Base unit

The Base unit should be placed on a level surface, in a position where:

- the mains adapter plug will reach an easily accessible 230-V AC switch mains supply socket - **never try to lengthen the mains power cable.**
- the **telephone line cable** will reach your telephone line socket or extension socket.
- it is **not close to a sink, bath or shower**, or anywhere else where it might get wet.
- it is **not close to other electrical equipment** - fridges, washing machines, microwave ovens, TVs, fluorescent lights, etc.

2. Plug the coiled handset cord into the Handset. Plug the other end into the jack on the left side of the Base unit.

Note: The base unit does require a battery.

3. Place the Handset in the Base unit.

4. Plug the telephone line cord into the PHONE LINE jack at the back of the Base unit. Plug the other end into a modular wall jack.

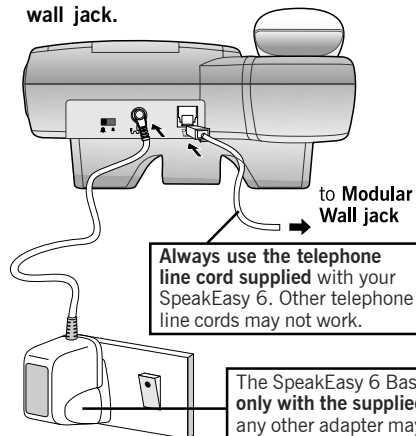

5. Plug the power supply cord into the POWER jack at the back of the Base unit. Plug the other end to a 230V AC, 50 Hz mains socket, with the switch on the socket set to OFF.

6. Switch ON the mains power at the socket.

7. Lift the Handset and check for Dial tone in the earpiece.

3. Desk/Wall mount installation

Desk Mount

To place the SpeakEasy 6 on a desk, connect the stand to the bottom of the phone in the slots near the ringer cover as shown below.

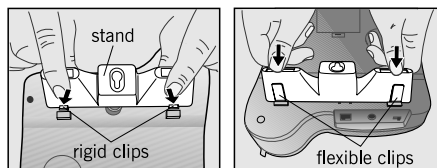

Insert the rigid clips of the stand into the slots on the bottom of the phone (near the ringer cover). Press down firmly until the flexible clips clicks into place.

To remove the stand, (1) pinch the flexible clips, (2) pull back the stand, and then (3) slide up and forward (3) as shown below.

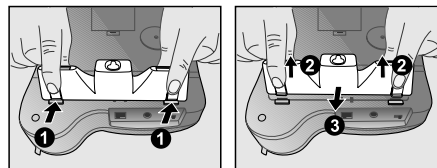

Wall Mount

To place the SpeakEasy 6 on a wall, connect the stand to the bottom of the phone in the slots near the battery cover as shown below.

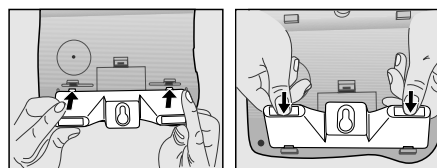

Binatone Help Line - 0845 345 9677 Calls are charged at Local Call rate.
5

Desk/Wall mounting continue...

Insert the rigid clips of the stand into the slots on the bottom of the phone (near the battery cover). Press down firmly until the flexible clips clicks into place.

To remove the stand, (1) pinch the flexible clips, (2) pull back the stand, and then (3) slide up and forward as shown below.

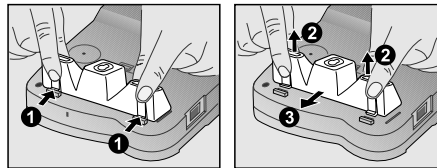

Mark two points on the wall that are 137mm apart to lay the fixing centers as shown below.

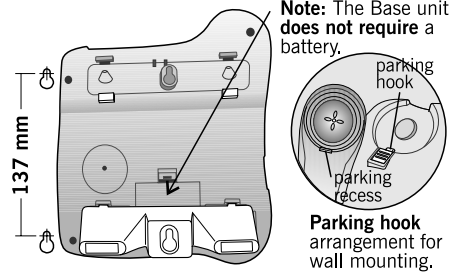









BE CAREFUL to check that there are no electrical wires hidden in the wall. Fix two screws (supplied with the unit) at the marked locations, leaving approximately 7mm between the wall and the screw head. Hang the cradle unit on the screws using the wall mount slots. *You may need to remove the telephone from the wall and tighten the screws so that the cradle is securely fixed and does not wobble.* Place the Handset on the cradle with the **parking hook** on the cradle arranged to fit in the **parking recess** under the earpiece on the Handset.

4. Setting up the SpeakEasy 6

The following section details how to set up your telephone. Press the **MENU** button to enter the **Options** menu and then use the **UP** or **DOWN** buttons to cycle through the following options:











- SET LANGUAGE
- SET TIME/DATE
- SET FLASH TIME
- LCD CONTRAST
- MESSAGE LENGTH
- RINGS TO ANSWER
- REMOTE ACCESS
- EXIT OPTION

! Note: The system will time out if you leave more than 15 seconds between key presses.





SET LANGUAGE			With the phone in standby mode;
	1		Press MENU button. ⇒ The display shows OPTIONS MENU ▲▼ .
	2		Press UP button to go to the language setting. ⇒ The display shows SET LANGUAGE .
	3		Press MENU button to confirm.
	4		Press UP or DOWN button to select ENGLISH (default), FRANCAIS , or ESPANOL .
	5		Press MENU button to confirm.
	6		Continue with programming, or press EXIT button to return to standby mode.
SET TIME/DATE	1		Press MENU button. ⇒ The display shows OPTIONS MENU ▲▼ .
	2		Press UP or DOWN button until the display shows SET TIME/DATE .
	3		Press MENU button to confirm. ⇒ The 'year' icon will be blinking.

Binatone Help Line - 0845 345 9677 Calls are charged at Local Call rate.

Setting up continue...



- 4  Press UP or DOWN button to set the year.
- 5  Press MENU button to confirm.
⇒ The 'month' icon will be blinking.
- 6  Press UP or DOWN button to set the month.
- 7  Press MENU button to confirm.
⇒ The 'date' icon will be blinking.
- 8  Press UP or DOWN button to set the date.
- 9  Press MENU button to confirm.
⇒ The 'hour' icon will be blinking.
- 10  Press UP or DOWN button to set the hour.
⇒ When setting the 'hour', the 'AM' or 'PM' icon will automatically turn ON to correspond the hour time.
- 11  Press MENU button to confirm.
⇒ The 'minute' icon will be blinking.
- 12  Press UP or DOWN button to set the minute.
- 13  Press MENU button to confirm the TIME and DATE setting.
- 14  Continue with programming, or press EXIT button to return to standby mode.

SET FLASH TIME







- 1  Press MENU button.
⇒ The display shows OPTIONS MENU ▲▼.
- 2  Press UP or DOWN button until the display shows SET FLASH TIME.
- 3  Press MENU button to confirm.
- 4  Press UP or DOWN button to select 100MS (default), 300MS, or 600MS.

Binatone Help Line - 0845 345 9677 Calls are charged at Local Call rate.







Setting up continue...

- 5  Press MENU button to confirm.
- 6  Continue with programming, or press EXIT button to return to standby mode.

LCD CONTRAST

- 1  Press MENU button.
⇒ The display shows **OPTIONS MENU ▲▼**.
- 2  Press UP or DOWN button until the display shows **LCD CONTRAST**.
- 3  Press MENU button to confirm.
- 4  Press UP or DOWN button to select your comfortable display viewing level (1~5). The default setting is 3.
- 5  Press MENU button to confirm.
- 6  Continue with programming, or press EXIT button to return to standby mode.







MESSAGE LENGTH

- To set the recording time for ICM and memo messages of the Answering machine.
- 1  Press MENU button.
⇒ The display shows **OPTIONS MENU ▲▼**.
- 2  Press UP or DOWN button until the display shows **MESSAGE LENGTH**.
- 3  Press MENU button to confirm.
- 4  Press UP or DOWN button to select 1, 2, 3, or 4 minutes. The default setting is 2 minutes.
- 5  Press MENU button to confirm the MESSAGE LENGTH setting.
- 6  Continue with programming, or press EXIT button to return to standby mode.





Binatone Help Line - 0845 345 9677 Calls are charged at Local Call rate.

Setting up continue...

RINGS TO ANSWER







- To set the number of rings before the machine answers a call;
- 1  **Press MENU button.**
⇒ The display shows **OPTIONS MENU ▲▼**.
 - 2  **Press UP or DOWN button until the display shows RINGS TO ANSWER.**
 - 3  **Press MENU button to confirm.**
 - 4  **Press UP or DOWN button to select TOLL SAVER, 2, 3, 4, 5, 6, 7, 8, or 9 rings. The default setting is 6.**
⇒ Use 'TOLL SAVER' when checking your SpeakEasy 6 for messages from a remote location using long distance service or from a pay phone. The Answering machine responds after the 2nd ring only if you have a new message waiting. If there are no new messages, the phone will answer after the 4th ring. You can then hang up after the 3rd ring to avoid paying for the call.
 - 5  **Press MENU button to confirm.**
 - 6  **Continue with programming, or press EXIT button to return to standby mode.**

REMOTE ACCESS

- The **REMOTE ACCESS** is a three-digit code you need if you call away from home to check your messages. The default is 321. You can change it to any three digits you want.
- 1  **Press MENU button.**
⇒ The display shows **OPTIONS MENU ▲▼**.
 - 2  **Press UP or DOWN button until the display shows REMOTE ACCESS.**
 - 3  **Press MENU button to confirm.**
⇒ The first digit of the code will be blinking.
 - 4  **Press UP or DOWN button to set the first digit of the REMOTE ACCESS code.**

Binatone Help Line - 0845 345 9677 Calls are charged at Local Call rate.

Setting up continue...

- 5  Press **MENU** button to confirm.
⇒ The second digit of the code will be blinking.
- 6  Press **UP** or **DOWN** button to set the second digit of the **REMOTE ACCESS** code.
- 7  Press **MENU** button to confirm.
⇒ The third digit of the code will be blinking.
- 8  Press **UP** or **DOWN** button to set the third digit of the **REMOTE ACCESS** code.
- 9  Press **MENU** button to confirm the **REMOTE ACCESS** setting.
- 10  Press **EXIT** button to return to standby mode.

5. Telephone Operation

Ringer volume





The **Ringer High-Low switch** located at the back of the Base unit allows you to adjust the volume of the ringer.

- High volume
- Low volume

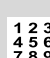
To make a call

- 1  Lift the handset or press **SPEAKERPHONE** button on the Base unit.
⇒ Check for dial tone.
- 2  Dial the telephone number.
⇒ The display shows the duration of the call in minutes and seconds.

Using the Pre-dial mode

- 1  Dial the telephone number.
- 2  Lift the Handset or press **SPEAKERPHONE** button on the Base unit to dial out the number.

Binatone Help Line - 0845 345 9677 Calls are charged at Local Call rate.

Telephone operation continue...

To answer a call



When the phone rings;

Lift the handset or press SPEAKERPHONE button on the Base unit.

⇒ The display shows the duration of the call in minutes and seconds .

To adjust the speakerphone volume



During a call;

Adjust the volume of the speakerphone to your comfortable volume level using the SPEAKERPHONE volume switch located at the right side of the Base unit.

To end a call



Replace the Handset on the Base unit cradle or press SPEAKERPHONE button on the Base unit.

⇒ The SPEAKERPHONE light indicator will turn OFF.

To switch between the Handset and the Speakerphone



During a phone conversation through the Handset, press the SPEAKERPHONE button to speak hands-free. Replace the Handset on the Base unit cradle.

While in speakerphone mode, lift the Handset to enable a private conversation.

To mute the mouthpiece or microphone

1



Press MUTE button once.

⇒ While the microphone is muted, **MUTE** will be shown on the lower right corner of the display.

2



Press MUTE button again to get back to the call.

Binatone Help Line - 0845 345 9677 Calls are charged at Local Call rate.

6. Outgoing call record

Last Number redial

1



Lift the handset or press **SPEAKERPHONE** button.

2



Press **REDIAL/PAUSE** button.

⇒ The phone automatically redials the last number you called.

Viewing the Outgoing call records

1



In standby mode, press **REDIAL/PAUSE** button.

⇒ The most recent outgoing call record will be displayed.

2



Press **UP** or **DOWN** button to view the other records.

Making a call from the Outgoing call record

1



In standby mode, press **REDIAL/PAUSE** button.

2



Press **UP** or **DOWN** button to find the record you wish to call.

3



When the number is displayed, press **DIAL** button.

⇒ The phone automatically redials the number using the speakerphone mode. **Lift the Handset anytime to talk privately and to turn the speakerphone mode off.**

Deleting an Outgoing call record

1



In standby mode, press **REDIAL/PAUSE** button.

2



Press **UP** or **DOWN** button to find the record you wish to delete.

3



When the record is displayed, press **DELETE** button.

⇒ The display prompts **DELETE?**

4







Press **DELETE** button again to confirm.

⇒ The display shows next record.



Binatone Help Line - 0845 345 9677 Calls are charged at Local Call rate.

Outgoing call record continue...



- | | | | |
|--|---|---|--|
| Storing an Outgoing call record into the Phonebook memory | 1 |  | When viewing the Outgoing call records, press UP or DOWN button to find the record you wish to store. |
| | 2 |  | When the record is displayed, press PHONEBOOK button.
⇒ The display shows the cursor blinking on the first digit of the number.
⇒ To modify the number, press UP or DOWN button to move the cursor to the number you want to change then input the new one or press DELETE button to delete. |
| | 3 |  | Press PHONEBOOK button to confirm. |
| | 4 | | Input the name. <i>See page 15 for entering letters.</i>
⇒ To modify an existing name, press UP or DOWN button to move the cursor to the character you want to change then input the new one or press DELETE button to delete. |
| | 5 |  | Press PHONEBOOK button again to save the record into the Phonebook memory. |

7. Phonebook





The Phonebook can store up to 120 names (max. of 15 characters) and telephone numbers (max. of 24 digits) in the Memory.

- | | | | |
|--------------------------------------|---|---|--|
| To view the Phonebook records | 1 | | Make sure the Handset is idle (not connected to a call). |
| | 2 |  | Press PHONEBOOK button.
⇒ The display shows SEARCH ADD , with the 'SEARCH' option blinking. |
| | 3 |  | Press PHONEBOOK button again.
⇒ If the Phonebook memory is empty, the phone will automatically return to the standby display. Otherwise, the first alphanumeric Phonebook entry will be shown. |
| | 4 |  | Press NUMERIC key (2/ABC ~ 9/wxyz) button that corresponds to the first letter of a Caller's |

Phonebook continue...

- 5  Press UP or DOWN button to scroll through the other records.
- 6  Press EXIT button repeatedly to return to standby mode or wait until the program times out.

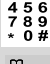

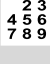
To add a new record into the Phonebook

- 1  Press PHONEBOOK button.
⇒ The display shows SEARCH ADD, with the 'SEARCH' option blinking.
- 2  Press UP or DOWN button to select 'ADD.'
- 3  Press PHONEBOOK button to confirm.
⇒ The display shows the cursor blinking on the number field.
- 4  Input the telephone number, maximum of 24 digits.
- 5  Press PHONEBOOK button to confirm.
⇒ The display shows the cursor blinking on the name field.
- 6  Input the name, maximum of 15 characters using keypad buttons 2/ABC to 9/WXYZ.
⇒ Refer to the table below to get the following characters.



Telephone Keypad characters

Keypad Buttons	1st Press	2nd Press	3rd Press	4th Press	5th Press
1	1	/	,	.	-
2/ABC	A	B	C	2	
3/DEF	D	E	F	3	
4/GHI	G	H	I	4	
5/JKL	J	K	L	5	
6/MNO	M	N	O	6	
7/PQRS	P	Q	R	S	7
8/TUV	T	U	V	8	
9/WXYZ	W	X	Y	Z	9
0	0	Space			







Phonebook continue...

- | | | |
|---|---|---|
| 7 |  | Press PHONEBOOK button to confirm. |
| 8 |  | Press EXIT button repeatedly to return to standby mode or wait until the program times out. |

To make a call from the Phonebook

- | | | |
|---|---|--|
| 1 |  | When viewing the Phonebook records, press UP or DOWN button to find the record you wish to call. |
| 2 |  | Press DIAL button. The phone automatically dials the displayed record.
⇒ The SpeakEasy 6 dials the number using the speakerphone mode. Lift the Handset anytime to talk privately and to turn the speakerphone mode off. |

To edit a stored number and/or name

- | | | |
|---|---|--|
| 1 |  | When viewing the Phonebook records, press UP or DOWN button to find the record you wish to edit. |
| 2 |  | When the record is displayed, press PHONEBOOK button.
⇒ The display shows the cursor blinking on the first digit of the telephone number. |
| 3 |  | Press UP or DOWN button to move the cursor to the digit you wish to change then input the new one or press DELETE button to delete. |
| 4 |  | Press PHONEBOOK button to confirm.
⇒ The display shows the cursor blinking on the first character of the name. |
| 5 |  | Press UP or DOWN button to move the cursor to the character you wish to change then input the new one or press DELETE button to delete. |
| 6 |  | Press PHONEBOOK button to save the edited record. |
| 7 |  | Press EXIT button repeatedly to return to standby mode or wait until the program times out. |

Binatone Help Line - 0845 345 9677 Calls are charged at Local Call rate.

Phonebook continue...

To delete a record from memory

1



When viewing the Phonebook records, press UP or DOWN button to find the record you wish to edit.

2



When the record is displayed, press DELETE button.

⇒ The display prompts **DELETEP**

3



Press DELETE button again to confirm.

⇒ The display shows next Phonebook record.

4



OR press EXIT button to cancel and return to the previous menu.

Press EXIT button repeatedly to return to the standby mode or wait until the program times out.

8. Caller Display operation

VERY IMPORTANT: The Caller Display feature of this product requires a subscription to Caller Display service from your telephone company.

If you subscribe to this feature from your local telephone company, you can see the phone number of the person calling you before you answer. The caller display information includes:

- The caller's number (max. 23 digits).
- The date and time of the call.
- The caller's name (max. of 15 characters) if the network sends it.

Note:

1. The Caller Display information will also include a name from the phonebook if the incoming number fully matches an entry in the Phonebook.

Binatone Help Line - 0845 345 9677 Calls are charged at Local Call rate.

Caller Display operation continue...

The place origin of the Caller Display record will display a special network message as:

Message	Significant
WITHHELD	The caller hides his number.
UNAVAILABLE	The caller's number is out of the network area.

Withheld and Unavailable calls are saved in the calls list and show as missed calls.

Caller Display list

This phone automatically stores the last 99 calls received. **It stores the data even if a power failure occurs.** When the caller display list is full, the new caller display entry will replace the oldest record.

The NEW CALL light indicator will turn on to show that you have a new Caller Display call stored in memory. The light indicator will turn off only after viewing ALL new caller display records.

Viewing the
Caller
Display list

1



2



3



With the phone on standby mode, press UP or DOWN button.
⇒ The display shows the most recent record. If there are no Caller Display records, the display will show **NO CALLS**.
⇒ The **'MSG'** icon will show to indicate that the caller has recorded a message.

Press UP or DOWN button again to scroll to the next Caller Display record.
⇒ The display shows **END OF LIST** upon reaching the end of the first and last record.

Press EXIT button to return to standby mode or wait until the program times out.

Caller Display operation continue...

To return a call from the Caller's list



When the Caller Display record is displayed;
Press DIAL button.
⇒ The phone automatically dials the displayed record.

Storing an Outgoing call record into the Phonebook memory



When viewing the Caller Display records, press UP or DOWN button to find the record you wish to store.



When the record is displayed, press PHONEBOOK button.
⇒ The display shows the cursor blinking on the first digit of the number.



⇒ To modify the number, press **UP** or **DOWN** button to move the cursor to the number you want to change then input the new one or press **DELETE** button to delete.



Press BOOK button to confirm.

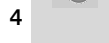

Input the name. See page 15 for entering letters.
⇒ To modify an existing name, press **UP** or **DOWN** button to move the cursor to the character you want to change then input the new one or press **DELETE** button to delete.



Press BOOK button again to save the Caller Display record into the Phonebook memory.

To delete a Caller Display record



When the Caller Display record is displayed;
Press DELETE button.
⇒ The display prompts **DELETE CALL?**



Press DELETE button again to confirm.



Press EXIT button to return to the standby mode.

Binatone Help Line - 0845 345 9677 Calls are charged at Local Call rate.

Caller Display operation continue...

To delete
all Caller
Display
records

1



When the Caller Display record is displayed.

Press and hold DELETE button.

⇒ The display prompts **DEL ALL CALLS?**

2



Press DELETE button to confirm.

⇒ The display automatically returns to standby mode.



OR press EXIT button to cancel and return to the previous menu.

9. Answering Machine system

Outgoing
Messages
(OGM)

An OGM is the announcement callers will hear when the machine answers a call. The Caprice 600 has two pre-recorded announcements available if you choose not to record your own OGMs.

■ **OGM1** - this invites callers to leave a message after the tone. The default is **"Please leave your message after the beep"**.

■ **OGM2** - this informs callers to call later and does not give them the opportunity to leave a message. The default is, **"Please call later."**

The machine has enough memory to record about 20 minutes of messages (OGM/Caller's message/Memo). When there is no further memory available to record, it will answer after 15 rings and the machine will announce, **"Memory full, please call later."** The display shows **MEMORY FULL** and it will be shown alternately with **MESSAGES** and **NEW**

To play the
current
OGM



Make sure the machine is switched on;





Press OGM button.

⇒ The display shows **PLAY OGM**, and plays the current announcement.





Binatone Help Line - 0845 345 9677 Calls are charged at Local Call rate.

Answering Machine System continue...

To record OGM 1

- 1  Press EXIT/ON-OFF button briefly until you hear, "Announcement 1."
- 2  Press and hold OGM button until you hear a 'beep.'
⇒ The display shows **OGM RECORDING** and the message counter starts to count.
- 3  Start recording your OGM1. Speak directly into the Base unit's Microphone from a distance of about 15 cms. (6 inches).
- 4  As soon as you have finished speaking, press EXIT/ON-OFF button to stop recording.
⇒ The display shows **PLAY OGM**, and your recorded message will be played back for your approval.

To record OGM 2

- 1  After setting the OGM1, briefly press EXIT/ON-OFF button again. You will hear, "Announcement 2."
- 2  Press and hold OGM button until you hear a 'beep.'
⇒ The display shows **OGM RECORDING** and the message counter starts to count.
- 3  Start recording your OGM2. Speak directly into the Base unit's Microphone from a distance of about 15 cms. (6 inches).
- 4  As soon as you have finished speaking, press EXIT/ON-OFF button to stop recording.
⇒ The display shows **PLAY OGM**, and your recorded message will be played back for your approval.

Binatone Help Line - 0845 345 9677 Calls are charged at Local Call rate.

Answering Machine System continue...

To turn the Answering machine ON or OFF



- 1 Press and hold EXIT/ON-OFF button to turn ON the answering system.
⇒ You will hear, "Answering machine ON." The display shows ANSWER ON and the MESSAGE light will light up.
- 2 Press and hold EXIT/ON-OFF button again to turn OFF the answering system.
⇒ You will hear, "Answering machine OFF." The display shows ANSWER OFF and the MESSAGE light will turn off.

Note: Once turned OFF, you can still call the machine and it will answer after 15 rings.

To switch between OGMs



- Press and release EXIT/ON-OFF button to switch between OGM1 and OGM2.
⇒ The machine does not record messages with OGM2 (Announcement 2) selected; make sure OGM1 is selected if you want callers to leave messages.

To record a memo



You can record a memo directly into the machine. **The length of the memo message recording depends on the MESSAGE LENGTH setting, see page 9.**

The memo message will be played back together with any messages from callers.

- 1 With the Handset on hook, press and hold MEMO button until you hear a 'beep'.
⇒ The display shows MEMO RECORDING and the message counter starts to count.
- 2 Start recording your memo. Speak directly into the Base unit's Microphone from a distance of about 15 cms. (6 inches).
- 3 As soon as you have finished speaking, press EXIT/ON-OFF button to stop recording.
⇒ Day and time are automatically stamped at the end of the message.

Binatone Help Line - 0845 345 9677 Calls are charged at Local Call rate.
22





Answering Machine System continue...

To playback your message/s

If you have messages or memos, the display shows the total number of messages **MESS** and the **MESSAGE** light flashes.

If you have **new** messages or memos, the display shows **NEW** and it will be shown alternately with the total messages.

Playback and Pause

-  **Press PLAY/PAUSE button. The machine will play all new messages/memos.**
⇒ While a message is being played, the display shows **PLAY MESSAGE** for received messages; **PLAY MEMO** for recorded memos.
⇒ If there are no messages/memos present, you will hear, **"You have no messages."**
-  **To pause a message playback, press PLAY/PAUSE button again**
-  **Press PLAY/PAUSE button again to restart message playback, otherwise it will restart automatically after a 30-second pause.**
-  **After playing all new messages, press PLAY/PAUSE button again. The system will play all of its messages/memos.**

Repeat/Rewind

 To repeat the current message from the beginning, **press OGM/REWIND** button.

To replay the previous message, press **OGM/REWIND** button twice.

Skip/Fast Forward

 To skip to the next message, press **MEMO/SKIP** button.

Answering Machine System continue...

Stop playback



To stop the message playback, press the **EXIT/ON-OFF** button.

Volume Control



Use the **SPEAKERPHONE** volume switch located on the right side of the Base unit to adjust the volume of the loudspeaker during playback.

To intercept a call



If you hear the answering machine recording a message, you can intercept the call and speak to the caller, EITHER by:

Lifting the Handset,

or Pressing the **SPEAKERPHONE button on the Base unit,**

or lifting the Handset of any other phone connected to the same line.

When you have intercepted the call, the machine will stop recording the caller's message.



If you intercept a call within 3 seconds of its start, you may sometimes need to press **EXIT/ON-OFF** button to stop recording.

To delete incoming messages

1



To delete the current incoming message;

During message playback, press DELETE button.

⇒ The display prompts **DELETE?**.

2







Press DELETE button again to confirm.

⇒ After the erasure is complete, the numeric order of the remaining messages will be rearranged.

Binatone Help Line - 0845 345 9677 Calls are charged at Local Call rate.

Answering Machine System continue...





- | | | | |
|-------------------------------|---|---|--|
| To delete all messages | 1 |  | After playing back all of your messages, press and hold DELETE button.
⇒ The display prompts DELETE ALL? |
| | 2 |  | Press DELETE button again to confirm, you will hear, "All messages erased."
⇒ The machine will not delete any messages that you haven't yet listened to. |
| | 3 | | The display automatically returns to standby mode. |

- | | | | |
|--------------------------------------|---|---|--|
| To go back to the default OGM | | | If you no longer want callers to hear the OGMs that you have recorded, you can delete them and revert to the pre-recorded defaults as follows: |
| | 1 |  | Make sure the machine is switched on.
⇒ If necessary, press and release the EXIT/ON-OFF button to switch to the OGM you want to delete. |
| | 2 |  | Press the OGM/REWIND button to play the current announcement. |
| | 3 |  | While the announcement is playing, press DELETE button.
⇒ The machine plays the pre-recorded OGM. |

Binatone Help Line - 0845 345 9677 Calls are charged at Local Call rate.

10. Remote operation

You can use the Answering System features of Speakeasy 6 when you are away from home. To protect your privacy, most of the features can be used only after you enter the three-digit **REMOTE ACCESS** Code.

To check your REMOTE ACCESS code	1		In standby mode, press MENU button.
	2		Press UP or DOWN button until the display shows REMOTE ACCESS .
	3		Press MENU button to display your code setting. ⇒ The default code is '321.'
	4		Press EXIT button to return to standby mode.

To check your messages from a remote location	1		Using a tone dialing phone, dial your home phone number.
	2		Listen to or bypass the OGM.
	3		Enter your REMOTE ACCESS Code.
	4		Press keypad "2" to playback your messages. ⇒ For other instructions, see the Remote Intruction code menu shown on the next page.

Notes:

- During remote operation, you must press a key within 10 seconds, otherwise the machine will cut off your call.
- If the machine pauses during playback, press keypad "2" within 10 seconds to continue. Otherwise, the machine will cut off your call.
- During remote playback, when the machine stops automatically after 168 seconds (about 2¾ minutes) a key must be pressed within 10 seconds, or the machine will cut you off.

Binatone Help Line - 0845 345 9677 Calls are charged at Local Call rate.

Remote operation continue...

Using the remote instruction code

The following is the Remote Instruction Code Help Menu:

To bypass the Outgoing Message, press “*”

To play new messages, press “2”

⇒ After playing back new messages, press “2” again to play all recorded messages.

⇒ To pause and restart during message playback, press “2”

To repeat message, press “1”

⇒ To skip back to the previous message, press “1” twice

To skip message, press “3”

To play announcement, press “4”

To record greeting, press “5”

To stop function, press “6”

To delete message, press “7”

To set Answer OFF, press “8”

To set Answer ON, press “9”

⇒ After setting to Answer ON, press “9” to switch between OGM1 and OGM2,

To delete all messages, press “0” twice

Switching ON from a remote location

If the answering machine is switched off, it will answer your call after 15 rings allowing you to switch the machine ON from a remote location;

- 1 **Using a tone dialing phone, dial your home phone number.**
- 2 **When you hear your outgoing message, press “*”**
- 3 **When you hear a ‘beep’, key in your REMOTE ACCESS code.**
- 4 **Press keypad “9” to switch ON.**

Binatone Help Line - 0845 345 9677 Calls are charged at Local Call rate.

11. Operational notes

Electrical safety

- **DON'T let the Base unit get wet.** Electrical equipment can cause serious injury if used while you are wet or standing in water.
- If the Base unit ever falls into **water**, **DON'T** retrieve it until you have unplugged the power lead from the mains and the telephone line plug from the telephone socket; then pull it out by the unplugged cables.
- **NEVER use your SpeakEasy 6 outdoors during a thunderstorm** - unplug the Base unit from the telephone line and the mains socket when there are storms in your area. Damage caused by lightning is not covered by the guarantee.

Locating the Base unit

The Base unit should be placed on a level surface, in a position where:

- the mains adapter plug will reach an easily accessible 230-V AC switch mains supply socket - **never try to lengthen the mains power cable.**
- the **telephone line cable** will reach your telephone line socket or extension socket.
- it is **not close to a sink, bath or shower**, or anywhere else where it might get wet.
- it is **not close to other electrical equipment** - fridges, washing machines, microwave ovens, TVs, fluorescent lights, etc.

Cleaning and care

- Don't clean any part of your SpeakEasy 6 with benzene, thinner or other solvent chemicals - this may cause permanent damage which is not covered by the Guarantee. When necessary, **clean it with a damp cloth.**
- Keep your SpeakEasy 6 away from **hot, humid conditions** or **strong sunlight**, and don't let it get **wet.**
- Every effort has been made to ensure high standards of reliability for your SpeakEasy 6. However, if something does go wrong, please **do not try to repair it yourself** - consult your supplier or the Binatone Help Line.

Binatone Help Line - 0845 345 9677 *Calls are charged at Local Call rate.*

12. Troubleshooting

! The SpeakEasy 6 must be serviced by trained engineers. NEVER attempt any repairs or adjustments yourself - you could make the problem worse and invalidate the Guarantee.

ALWAYS check first that:

- you have followed the steps listed in Section 2 to install and set up your SpeakEasy 6.
- all connectors are firmly inserted in their sockets.
- mains power is switched on at the socket.

Everyday use

"I cannot make or answer calls."

Make sure you're using the **telephone line cable** that was supplied with your SpeakEasy 6. Other telephone line cables might not work.

Switch off power at the mains socket, wait for a few seconds and then switch back on. This may solve the problem.

"The phone does not ring"

Make sure you're using the **telephone line cable** that was supplied with your SpeakEasy 6. Other telephone line cables might not work.

Set the ringer volume to **High**, using the switch at the back of the unit.

Check that the **total REN value** of all equipment connected to your telephone line is not more than 4. Disconnect one or more telephones.

"The phone does not dial"

Make sure you're using the **telephone line cable** that was supplied with your SpeakEasy 6. Other telephone line cables might not work.

"The Caller Display feature isn't working."

You need to **subscribe** to Caller Display service from your local telephone company. Contact the local telephone company for details on how to subscribe.

Binatone Help Line - 0845 345 9677 Calls are charged at Local Call rate.

Troubleshooting continue...

The caller may have **withheld** their number by dialing 141. Or they may be calling from a network that does not transmit the Caller Display (for example, it may be an international call).

Be sure to wait until the second ring before answering.

Answering Machine

"The machine won't record any messages"

The machine's memory may be full. You need to delete enough recorded messages to free at least one minute recording time. Or you can delete all recorded messages to make room for new ones

Make sure the machine is switched on - the **MESSAGE light** should be on.

Make sure you have not selected **OGM2** - with OGM2 selected, callers cannot leave messages (see page 20).

"Remote operation doesn't work."

Make sure you are using the correct **remote security code**.

Check that you are using a suitable tone-dialling phone. Some cordless or mobile phones do not generate continuous tones and so are not ideal for remote operation.

Don't leave more than 10 seconds between key presses; otherwise, your call will be cut off.

Using your SpeakEasy 6 on a PBX

"Last Number Redial and/or memory dialing don't work on a PBX."

When you first make a call, try pressing the **REDIAL/PAUSE** button for a **pause** between the outside line access digit (e.g. 9) and the telephone number. You should later be able to redial the number.

When storing numbers in memory, you can include the **outside line access digit** (e.g. 9) with each number.

Binatone Help Line - 0845 345 9677 *Calls are charged at Local Call rate.*

Troubleshooting continue...

If your PBX requires you to wait for a second Dial tone before dialing the telephone number, press the **REDIAL/PAUSE** button for a pause between the access digit and the number.

If the fault persists ...

Disconnect all other instruments connected to the same line as the SpeakEasy 6 and see whether you can make a call.

- **Disconnect the Base unit** from the telephone line and plug a different phone into the master telephone socket. Try making a call. If this works, the line is OK.
- If the call does not work, and you are using a **two-way socket adapter**, remove it and plug a telephone directly into the socket. If the call now works, the adapter may be faulty.

If you cannot make a call, the fault may be on the **exchange line**. Contact the service provider (the BT engineers on 151, or your cable company).

If you still cannot identify the cause of the problem, contact the **Binatone Help Line** on **0845 345 9677**. Calls are charged at Local Call rate.

Binatone Help Line - 0845 345 9677 *Calls are charged at Local Call rate.*

13. Guarantee and service

The **Binatone SpeakEasy 6** is guaranteed for 12 months from the date of purchase shown on your sales receipt. The Guarantee does not cover damage by misuse or negligence, or by excessive voltages - for example, faults on the telephone line, or lightning. This does not affect your statutory rights.

Please keep your sales (till) receipt - this is your guarantee. You should also keep the original packaging material.

In the unlikely event that you need to return your SpeakEasy 6 to our Repair Centre while it is under guarantee, there will be a £5 handling charge.

While the unit is under Guarantee

1. Disconnect the Base unit from the telephone line and the mains electricity supply.
2. Pack up all parts of your SpeakEasy 6, using the original packaging. Remember to include the mains adapter
3. Return the unit to the shop where you bought it, making sure you take your sales receipt.

After the Guarantee has expired

If the unit is no longer under Guarantee, first follow steps **1** and **2** as for repair under Guarantee. Then ...

3. Call our Service Department on **0845 345 9677** and ask for a quotation of the repair charge and details of where to send your SpeakEasy 6 for repair.
4. Make sure you include with your SpeakEasy 6:
 - your name and address.
 - a cheque or postal order for the value of the repair charge.
5. Return your SpeakEasy 6 to the address given by the Service Department.

Binatone Help Line - 0845 345 9677 *Calls are charged at Local Call rate.*

14. Technical details

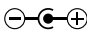
Standard	Corded Telephone with Caller Display and Answering Machine
Temperature range	Operating 0 °C to 40 °C Storage -20 °C to 60 °C
Electrical power	Base unit - input 230 V AC, 50 Hz; output DC 6 V, 350 mA; 2.1 VA; polarity 

Declaration of conformity

The Binatone SpeakEasy 6 complies with the essential protective requirements and objectives of:

- EC Low Voltage Directive 73/23/EEC
- EC EMC Directive 89/336/EEC

and conforms to the following relevant harmonized standards:

- Safety: EN 60950
- Other: I-CTR37, CTR38, EN55-022, EN55024



Waste electrical products must not be disposed of with household waste. This equipment should be taken to your local recycling centre for safe treatment.

Binatone operates a policy of continuous product improvement, and so reserves the right to make changes to the product and functions without notice.

Binatone Help Line - 0845 345 9677 Calls are charged at Local Call rate.
33

Connection and conditions for use

You can connect your SpeakEasy 6 to a direct exchange line (DEL) - a line connected to a local exchange, with its own phone number; to an extension socket connected to a DEL; or to an extension on an approved compatible PBX. Do not connect the SpeakEasy 6 as an extension to a payphone.

The **ringer equivalence numbers (RENs)** of all instruments (phones, fax machines, etc.) connected to an exchange line **must not add up to more than 4** - otherwise, one or more of them may not ring and/or answer calls correctly. The SpeakEasy 6 has a REN of 1, and most other telephones have a REN of 1 unless marked otherwise.

Contents of this User Guide

1. Where to find it
2. Installation
3. Desk/Wall mount installation
4. Setting up the SpeakEasy 6
5. Telephone operation
6. Outgoing call record
7. Phonebook function
8. Caller Display operation
9. Answering Machine system
10. Remote operation
11. Operational notes
12. Troubleshooting
13. Guarantee and service
14. Technical details

If you need help ...

The **Binatone Help Line** is available from 9.00 am to 5.00 pm, Monday to Friday, on

0845 345 9677

Calls are charged at Local Call rate.

Pressing buttons on your phone

- When the instructions in this user guide tell you simply to '**press**' a button, this means that you should **press the button briefly, then release it**.
- When the instructions tell you to '**press and hold**' a button, this means you should **keep the button pressed** until the display changes and/or you hear a tone.

UK Ver 1 Apr 06